

Scotchman[®]

ACAT

Metal Fabricating Solutions

AMERICAN
MANUFACTURER



He's the best
Fabricator
You'll ever have.

Give him the best
Machinery
He'll ever use.



- Ironworkers
- Upcut Saws
- Measuring Systems

- Circular Cold Saws
- Utility Band Saws
- Tube & Pipe Notcher/Grinders

The Solution **PREFERRED** by Metal Fabricators

January 2019

Optional Tooling

Porta Fab 45



6" Brake



8" Brake



12" Brake



Open End Brake



Pipe Notcher



Rectangle Notcher



90° V-Notcher



Tube Shear



Rod Shear



Strut Shear



Weld Coupon Bender



Picket Tool

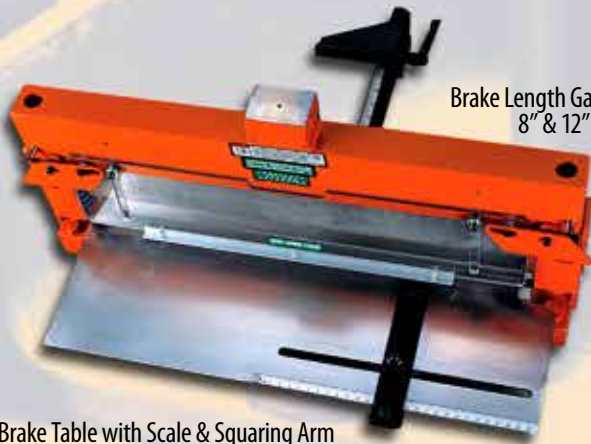

Brake Length Gauge with Scale
8" & 12" Brakes

Brake Table with Scale & Squaring Arm
12" Brake Only



30" Material Stop



LED Work Light

Optional Tooling 50514-EC, 5014-ET



6" Brake



8" Brake



12" Brake



Open End Brake



Pipe Notcher



Strut Shear



Weld Coupon Bender



90° V-Notcher



Rod Shear



Tube Shear



Picket Tool



Punch Gauging Table with Fence & Scale (50514-EC)



Shear Table with Miter Fence

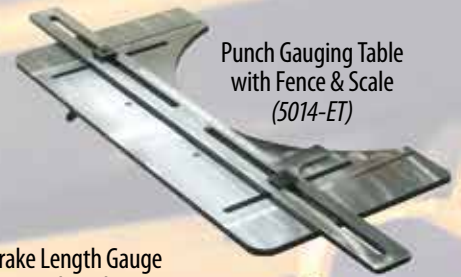

Brake Length Gauge with Scale 8" & 12" Brakes



Tool table extension with punch & die drawer



48" Back Gauge

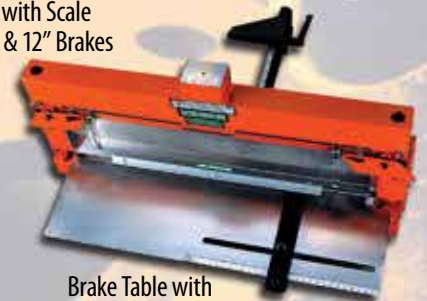

Brake Table with Scale & Squaring Arm 12" Brake Only

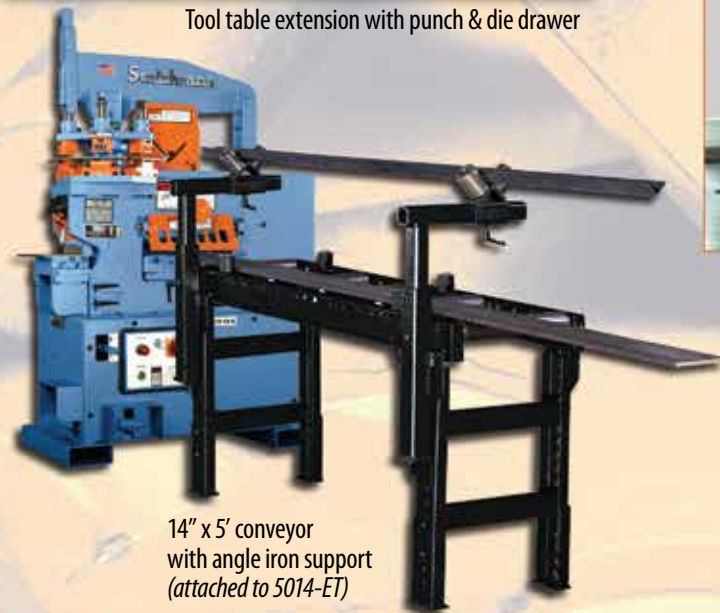

14" x 5' conveyor with angle iron support (attached to 5014-ET)



Laser Light



4" Angle Miter Guide



Jog Control



LED Work Light-Punch & Shear



LED Work Light-Punch, Shear, Notcher



Optional Tooling

6509, 9012, 12012, DO 70, DO 95, DO 120, DO 135, DO 150



12" & 24" Brake



Open End Brake



Pipe Notcher



90° V-Notcher



Rectangle Notcher



6" x 6" Die Holder



Channel Shear



Tube Shear



Rod Shear



Picket Tool



Offset Die Holder



Unequal Leg Angle Blades

Brake Length Gauge with Scale 12" & 24" Brakes



Strut Shear



Urethane Stripper



Brake Table with Scale & Squaring Arm 12" & 24" Brake



Weld Coupon Bender



48" Back Gauge

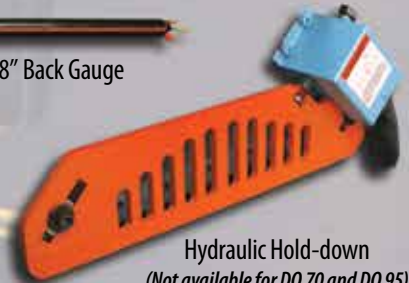

Hydraulic Hold-down (Not available for DO 70 and DO 95)



Multi-Loc Punch Gauging Table 36" and 85" extensions available



Laser Light



Punch Table Extension



Angle Iron Miter Guide



Tool table extension with punch & die drawer



24" x 5' conveyor with angle iron support (attached to DO 70/110)



LED Work Light: Punch & Shear

Optional Tooling

FI 8510-20M, DO 8514-20M



12" & 24" Brake



Open End Brake



Pipe Notcher



Offset Die Holder



90° V-Notcher



Tube Shear



Picket Tool



6" x 6" Die Holder



Urethane Stripper



Open End Brake for Notcher End (DO 8514)

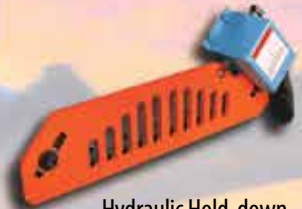

Hydraulic Hold-down (FI 8510-20M only)



Strut Shear



Channel Shear Blades (DO 8514)



Weld Coupon Bender



Optional Punch for Notcher End (DO 8514)



Punch Table Extension



48" Back Gauge

Brake Length Gauge with Scale 12" & 24" Brakes



Brake Table with Scale & Squaring Arm 12" & 24" Brake



Multi-Loc Punch Gauging Table 36" & 85" extensions



24" x 5' conveyor with angle iron support (attached to FI 8510-20M)



LED Work Light: Punch & Shear



Laser Light (FI-8510-20M ONLY)

Conveyor tables can be lined up to hold longer pieces and still have room for forklift access in between.



In-Stock Punches & Dies



#20 & #40 Rounds

1/8	11/16
5/32	23/32
3/16	3/4
13/64	25/32
7/32	13/16
1/4	27/32
17/64	7/8
9/32	29/32
5/16	15/16
11/32	31/32
3/8	1
13/32	1-1/32
7/16	1-1/16
15/32	1-3/32
1/2	1-1/8
17/32	1-5/32
9/16	1-3/16
19/32	1-7/32
5/8	1-1/4
21/32	

#45 Round Punches

1-9/32
1-5/16
1-11/32
1-3/8
1-13/32
1-7/16
1-15/32
1-1/2
1-17/32
1-9/16

Split Ring Round

1-5/8
1-3/4
2
2-1/4
2-1/2
2-3/4
3

#49 Round Punches

1-5/8	1-7/8
1-11/16	1-15/16
1-3/4	2
1-13/16	

Ovals

1/4 x 1/2	13/16 x 1
9/32 x 1/2	7/8 x 1
1/4 x 3/4	15/16 x 1
9/32 x 3/4	1/4 x 1-1/4
5/16 x 3/4	9/32 x 1-1/4
11/32 x 3/4	5/16 x 1-1/4
3/8 x 3/4	3/8 x 1-1/4
13/32 x 3/4	13/32 x 1-1/4
7/16 x 3/4	9/32 x 1-1/4
15/32 x 3/4	5/16 x 1-1/4
1/2 x 3/4	11/32 x 1-1/4
17/32 x 3/4	3/8 x 1-1/4
9/16 x 3/4	13/32 x 1-1/4
19/32 x 3/4	7/16 x 1-1/4
5/8 x 3/4	15/32 x 1-1/4
1/4 x 1	1/2 x 1-1/4
9/32 x 1	17/32 x 1-1/4
5/16 x 1	9/16 x 1-1/4
11/32 x 1	19/32 x 1-1/4
3/8 x 1	5/8 x 1-1/4
13/32 x 1	21/32 x 1-1/4
7/16 x 1	11/16 x 1-1/4
15/32 x 1	23/32 x 1-1/4
1/2 x 1	3/4 x 1-1/4
17/32 x 1	25/32 x 1-1/4
9/16 x 1	13/16 x 1-1/4
19/32 x 1	7/8 x 1-1/4
5/8 x 1	15/16 x 1-1/4
21/32 x 1	7/16 x 1-1/2
11/16 x 1	9/16 x 1-1/2
23/32 x 1	11/16 x 1-1/2
3/4 x 1	13/16 x 1-1/2
25/32 x 1	15/16 x 1-1/2

Squares

1/4
9/32
5/16
11/32
3/8
13/32
7/16
15/32
1/2
17/32
9/16
19/32
5/8
21/32
11/16
23/32
3/4
25/32
13/16
27/32
7/8
29/32
1
1-1/32

Hexagon

7/16
1/2
11/16
3/4

Corner Turning

1/2
3/4

Trimming & Cut Off

3/4
1

Round Metric

5 mm	19 mm
6 mm	20 mm
7 mm	21 mm
8 mm	22 mm
9 mm	23 mm
10 mm	24 mm
11 mm	25 mm
12 mm	26 mm
13 mm	27 mm
14 mm	28 mm
15 mm	29 mm
16 mm	30 mm
17 mm	31 mm
18 mm	32 mm

Round Offset Dies

9/32
5/16
11/32
3/8
13/32
7/16
15/32
1/2
17/32
9/16
19/32

#40 Punch

1/8" Thru 1-1/4"
3 mm Thru 31 mm

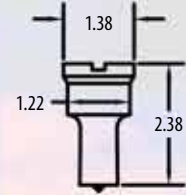

#45 Punch

1-9/32" Thru 1-9/16"
32 mm Thru 36 mm

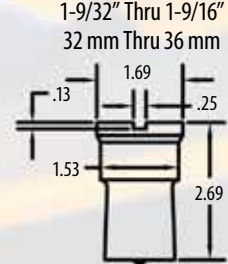

#49 Punch

(12012, DO 120, DO 135, DO 150 Machines Only)
1-5/8" Thru 2"
37 mm Thru 52 mm

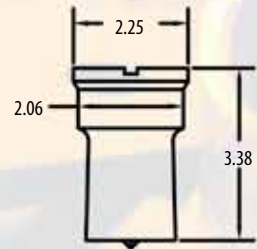

Split Ring Punch

Thru 4"

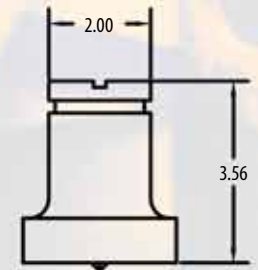

#20 Punch

1/8" Thru 2-1/4"
3 mm Thru 57 mm

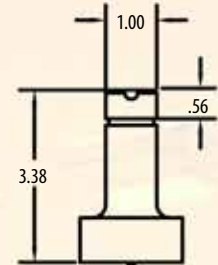

Special Punches & Dies



#82 Die

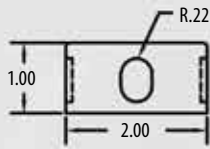

#86 Die

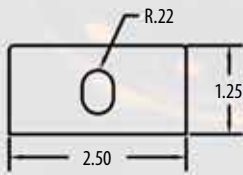

3" Die

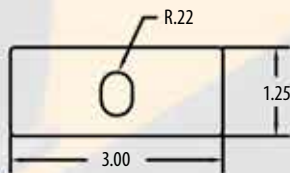

6 x 6 Die

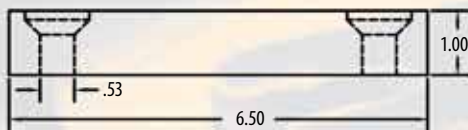

#20 Die

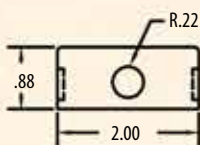

CUSTOM TOOLING

Various tooling options and hundreds of punches and dies are available for every model. In addition, our engineers design and build custom tooling for your unique applications.

Contact us at info@scotchman.com for more information.





Continuing the legacy
of **Art Kroetch**
(1926-2007)

Founder of
Scotchman Industries
(Est. 1967)

Scotchman Industries is family-owned and located in small town South Dakota. Our factory representatives assist dealers worldwide. We are honored to have served the manufacturing industry for over 50 years.

Our company was founded on the principle of providing well-built machinery to help our customers find efficient solutions for their shop needs. We remain committed to building high-quality & dependable USA made products, providing first-class customer service, and have confidence in the strength of American manufacturing.

We believe that building a manufacturing interest among our Nation's youth is vital to the future of American manufacturing and we support shop class education and trade schools.

When you buy a Scotchman machine, you'll have peace of mind knowing you're supporting an American company who is supporting the community.



Rebuilding American Manufacturing One Veteran At A Time™

Scotchman

Metal Fabricating Solutions



Sales partner in México:



ACAT Mexicana
Ave. Regio Parque #200 Regio Parque Industrial
Apodaca, Nuevo León, México CP. 66633

✉ acat@acatmexicana.com ☎ TEL. 81 8354 8910

www.acatmexicana.com

Follow Us On

